



# BATTERY BACKUP SUMP PUMP SYSTEM 1850



PHCC-1850



B12-100

## Pro Series Standby Battery

- Runs the pump longer and for more hours per charge
- Lasts longer in standby operation

- Automatic battery backup system for premium security and peace of mind
- Dual float switch for added redundancy
- Designed for use with maintenance-free or wet-cell batteries
- USB data port and remote terminal allow the system to connect to various devices for real-time alerts

*Industrial Grade for the Residential Market*

[www.StopFlooding.com](http://www.StopFlooding.com)

800-991-0466



# BATTERY BACKUP SUMP PUMP SYSTEM 1850

## Features

- Dual float switch for added reliability
- Recharges automatically
- Monitors system conditions and alarms when:
  - Battery is discharged or needs to be replaced
  - Battery cable is loose or corroded
  - Power plug is disconnected, fuse is blown, circuit breaker is tripped, or AC power is out
  - Backup pump has been activated
- Detects irregularities, sounds an alarm, and pinpoints problems and solutions on the control panel
- Alarm can be silenced during a power outage
- Runs pump weekly to exercise and extend pump life
- USB data port and remote terminals connect to external devices such as the Pro Series CONNECT Module, home security system or other devices for remote notification
- Designed for use with maintenance-free or wet-cell batteries

## CONNECT

The Pro Series CONNECT™ line of pumps have the ability to send an email, text or push notification when an issue arises or maintenance is needed.

### Notification with the USB Data Port:

- Attach the Pro Series CONNECT Module to your Pro Series 1850 backup system and the module will act as a gateway to the Internet
- Receive specific text, email or push notifications telling you exactly what is going on in the home

### Notification with the Remote Terminal

- Connects to a home security or other dry-contact-based device

Now, you can be in the know when you're on the go!

## Install Diagram

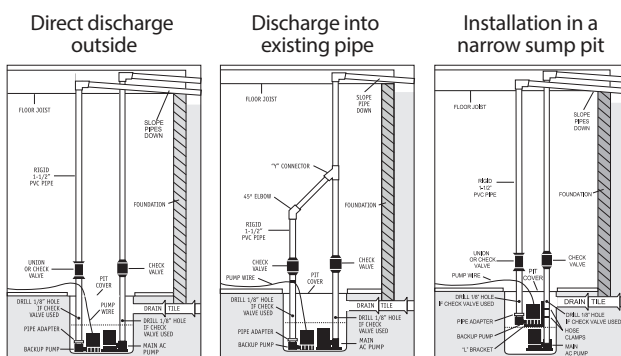

Available from:

## Specifications

### Pump

Flow	1,850 GPH
Amp. Draw @10 ft Head	12 Amps
Max Head	16 ft (4.9 m)
Inlet	Snap-on, Noncorrosive ABS Screen
Motor Type	Brush-type DC
Voltage	12 VDC

### Charger/Monitor

Power Input	115 VAC, 60Hz
Output Voltage/Current	12 VDC/1.6 Amps
Pumping Time:	
B12-100	70 Hours*
B12-100 x 2	140 Hours*
Intermittent Duty	Days of Pumping
Float Switch	Dual micro-reed switch with protective cage
Shipping Weight	12.0 lb (5.4 kg)

\*Run time based on 10% duty cycle; runtimes may vary based on flow

## Construction

- Noncorrosive, ABS pump housing
- Noncorrosive ABS impeller
- Stainless-steel shaft and fasteners
- Rulon seal

## Flow Chart

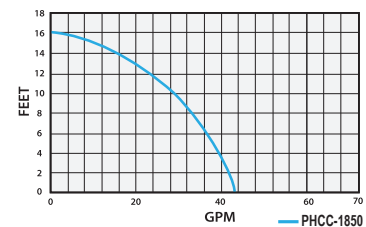

## Included with System

- 12 VDC sump pump
- Control unit with lights and alarms
- USB port on control unit for CONNECT module
- Dual float switch
- Snap-on, noncorrosive screen
- 1.5-inch pipe adapter
- Battery box
- Charger